



# SOUTHPORT ECHO

VOLUME 42 ISSUE 5 MAY 2014

## INDEX

Articles	Page No.
Elections coming	1
Jobs Available	1
KPL 1/1 genealogy	2
Meeting/Program	1
Prepare for Madison	4
Recommended websites	6
Show and Tell	2
Surnames Researched	2
Sunshine's Corner	2
Vale Cemetery	3&6
WI History Library	5

## ELECTIONS COMING IN JUNE

Next month we will be voting on the positions of President and Secretary. Both are for 2 year terms. Please make sure to be there for voting at the June Meeting on June 9, 2014.



## MEETING TIME / PLACE

Second Monday of the month (No meeting in July or August) 6:00 pm Social 6:30 PM Meeting/Program

At Gateway Technical College  
3520 30th Avenue Kenosha,  
Wisconsin 53140

Our meeting will take place in the Madrigano Auditorium at Gateway Technical College. The Auditorium building is to the north and back of the Main GTC Building

Check our Website Calendar for the most up to date location at [www.kengensoc.com](http://www.kengensoc.com)

## PROGRAMS

### **Monday May 12, 2013**

Military Genealogy. Our guest speaker will be Tina Beaird, the Genealogy/Local History Librarian at the Plainfield Public Library. Covering the Military from America's Revolutionary war to World War II.

## JOBS AVAILABLE

We are looking for someone to be our corresponding secretary. You would help respond to requests for genealogy information regarding their research. This involves going to the courthouse, Kenosha Public Library, The Archives Library at Parkside, and cemeteries. This may also involve some research. You would also attend monthly board meetings on the 1st Monday of each month. - [Mary Ann Cole will be our new Corresponding Secretary.](#)

We are also looking for someone to make posters for our monthly speaker and meeting. This involves using a computer, using clip art, taking the posters to the printer and distributing them around town to approximately 10 places. [A couple of meetings ago, someone said they would do this and I forgot to write their name down \(Oops\). Please contact me ASAP.](#)

Our editor of the newsletter "The Echo" will be moving away soon. We need to find a replacement before she leaves so you would get some training on how to publish the newsletter. This involves using a computer, putting the newsletter together, taking notes at meetings to write up articles for the newsletter, taking pictures, and doing general research to write up how to articles. You would also attend monthly board meetings on the 1st Monday of each month.

Last, but not least, we are looking for a reporter for our newsletter. This involves using a computer, interviewing people, researching topics for future stories, backing up the editor when they are not able to attend our general meetings and assisting the editor in publishing the newsletter. If you are interested in any of the above positions, please see me after the meeting or call me at 262-764-2630

~~~~Judy Uelmen, President of KCGS~~~~

## **Show & Tell**

### **Kenosha County Genealogy Society Meeting on April 14, 2014**

By Suzanne K. Dibble

Almost two dozen members and one guest, came with their genealogy research projects. Most everyone stood up to show and tell about their programs in researching their genealogy research projects. Most everyone stood up to show and tell about their progress in researching their 'brick walls' they have gotten through, while others explained about the problems still preventing them is go further.

One person has been able to go back about 900 years, and that person is Jim Hackett. He told us about the multiple brick walls he has managed to break through, his findings of his family research. It is a remarkable feat and he is very proud of his accomplishments.

One story is about a married couple Edmond Hackett and his wife Anna (nee-Rokel) were working on a reconstruction of an Anglican Church in Fetherd, Tipperary, Ireland. This church was already hundreds of years old in 1508, when an accident happened and they both died.

They were buried together in a crypt in the back of the church with the information carved on the top. There is also a carving of the Hackett crest on one of the supporting pillars. What a find that must have been for Jim.

Through the relating of everyone's stories, we relived their experience, we relived their experiences, of researching family history. The highs of reaching the goals and the lows of not finding anything. Everyone enjoyed the experiences others have been through. We all were enthusiastic about doing show and tell again in the future.

#### **Sunshine's Corner by Claudia Dibble-Schiller**

##### **SPREADING SUNSHINE TO MEMBERS:**

Joyce March is still recovering and would like to hear from members. Cards can be sent to:

Joyce March c/o St. Francis Terrace,  
Room 112-1  
3200 South. 20th street,  
Milwaukee, WI 53215-4442

A Best wishes and prayers for a speedy recovery sent for Sylvia Canada's brother's recent surgery

A wish along with our prayers for a speedy recovery to Maureen Kueny who is receiving

#### **Surname being Searched**

Contact via website at [www.kengensoc.com/](http://www.kengensoc.com/) for further info.

##### **Name Researcher No. Name Researcher No**

|            |    |           |    |
|------------|----|-----------|----|
| Lockman    | 5  | Fischbach | 37 |
| St. George | 36 | Nelson    | 29 |
| Bull       | 60 | Usa/Uza   | 44 |
| Hollenbeck | 65 | Weiland   | 35 |
| Obeliske   | 31 | Raquet    | 32 |

#### **Genealogy consultation session**

We will be having the last of our 1 to 1 consulting sessions to assist fellow genealogist at Kenosha Public Library-Southwest for this spring. The session will be on Wednesday, May 21, 2014 from 6 pm to 8:30 pm at:

Kenosha Public Library — Southwest  
7979 38th Avenue  
Kenosha, WI 53142

Sign-up will be at the May meeting.

It's best if you have your own laptop although there are two available laptops for our use by the library. We will also need one or two greeters to help people to sign-in and help in filling out a family tree.

[Make sure whenever you go to the Library, to ask for a suggestion card and make a request for a genealogy section to do research. Also remember to leave the books you look at are left out for the library staff can reshelf. This way they know they are being used.]

## VALE CEMETERY

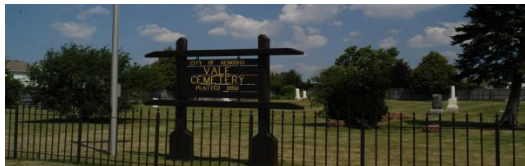

{In the surveys I asked for you to fill out. Two members wanted background information on the Vale cemetery. I didn't find a great deal but this is a bit of it.}

Vale is a small public cemetery on Northside of 75 street/Hwy 50 and east of 96<sup>th</sup> Avenue at the entry to the White Caps subdivision. When turning north onto 96<sup>th</sup> Avenue take a quick right into a small parking area just before the entrance to the cemetery. The GPS coordinates are 42° 34' 03"N, and 87° 55' 27"W in Somers Township.

The first person to be buried there was the 53yr old wife the property's owner John Vale. Her name was Alice Vale and she died in 1848. By 1860 there were at least a dozen more internments there. At that time the approximate one (1) acre of land was donated to the county and then was designated as Vale cemetery. In the 1990's after a complaint by a visitor to the cemetery about the condition of the site, there were irreparably damaged and broken headstones, some eroded into the ground making the inscription barely visible plus untrimmed grasses and weeds. This is when the county took over the maintaining of the cemetery. There are only about 120 gravesites marked at this time. In the 1970's our society's former and late president Lois Stein created a record of the cemetery's inhabitants as follows and with added gravesites by John Hewes in 2003.

**Bailey**, Denorma, d. 17 Apr 1869, age: 52y; **Barter**, Frederick, b. 5 Apr 1840, d. 23 Jul 1927~Hester, d. 7 Oct 1878, age: 66y, Wife of William Barter-Sarah, b. 31 Jul 1846, d. 15 Jul 1916~William, d. 19 Nov 1878; **Bertalot**, Jane Brice, b. 23 Mar 1843, d. 2 Jan 1875, Daughter of Thomas & Jane Brice, wife of Edward Bertalot; **Bornhiton**, Sarah, 1830, Surname difficult to read, date may be death or birth date; **Brande**, Frederick J., d. 10 Feb 1889, age: 64y~Lavina J., d. 20 Apr 1893, age: 73y~Sarah, d. 17 Jul 1889, age: 64y~W., Rev., d. 29 Jul 1851, age: 71y; **Breddek**, Anton, no dates; **Brice**, Jane, b. 1804, d. 1888, Mother~John S, b. 1836, d. 1926~Thomas, b. 1800, d. 1893, Father; **Callow**, Lilly J, b. 1890, d. 1949, Mother~Wesley H., b. 1891, d. 1970, Father; **Christensen**, Mary Whiteley, b. 7 Aug 1871, d. 22 Aug 1916; **Curtiss**, Z, d. 12 Jul 1853; **Duchton**, A M R, d. ??, Broken Stone; **Gady**, Florence, d. 15 Mar 1858, Baby of H F & L J Gady; **Gerdes**, Marion E, b. 1917, d. 1957, Mother; **Gilbert**, Alice T, d. 8 Sep 1856, age: 7w 3d~Capt J L, d. 20 Oct 1863, age: 66y 7m~Charles T, d. 6 Sep 1859, age: 4m 19d~Eva A, d. 16 Jun 1862, age: 9y~George O, d. 23 Mar 1852, age: 80y~Silas M, d. 5 May 1855, age: 2m 15d~ Theodora, d. 2 Jun 1865, age: 87y, Wife of G O Gilbert; **Henshaw**, Joseph, d. 9 Jan 1853, age: 77y 9m; **Henthorn**, Robert, b. 1903, d. 1954, Father; **Hintz**, Arthur A, b. 1902, d. 1977; **Holbrook**, Susan, d. 30 Sep 1850, age: 17y 11m 16d, Wife of William Holbrook; **Holt**, Lydia, d. 19 May 1860, age: 70y 5m, Wife of Joseph; **Johnson**, Anna, b. 1853, d. 1919~Charles H, d. 22 Mar 1867~Chris H, b. 1895, d. 1939~Claus, b. 1846, d. 1929~Henry, d. 22 Feb 1868, age: 73y~Julia, d. 1852~Violata, d. 12 Jun 1865, age: 62y 1m 23d, Wife of Henry Johnson; **Lieber**, Charlie A, d. 5 Aug 1864, age: 36 6m~Clarrisa, d. 8 Jan 1902, age: 77y~Francis M, d. 19 Oct 1874, age: 21y~James, d. 26 Oct 1876, age: 53y~Lafayette, d. 7 Aug 1866, age: 17y~Mary A, d. 28 Oct 1862, age: 3m~William, b. 1836, d. 1864, Pvt Co H 33 I Reg Vol CW~William, d. 22 Sep 1862, age: 26y 8m; **Lucas**, Sarah J, d. 4 May 1861, age: 23y 2m 18d, Wife of John Lucas; **Ludwig**, Laura Jean, b. 1938, d. 1950~Victor M, b. 12 Jul 1913, d. 3 Aug 1967, Father; **McClaughey**, Clarissa, d. 16 Nov 1869, age: 23y 7m; **McNeil** Addie, b. 5 Sep 1850, d. 15 Nov 1922~Elizabeth, b. 1896, d. 1964~George, b. 10 Aug 1843, d. 15 Sep 1923~Laura, b. 29 Aug 1853, d. 11 Jun 1901~Raymond C, b. 1886, d. 1944~Sarah, b. 6 Aug 1809, d. 7 Oct 1892~William Earl, b. 28 Oct 1875, d. 1 Jan 1948~William, b. 12 Feb 1804, d. 25 Jul 1870; **Nelsen**, P C, d. 16 Sep 1878, s/o P & B~Peter, d. 2 Dec 1881, Son~Petrea, d. 15 Dec 1881, age: 40y 4m, w/o Peter~W V, d. 12 Sep 1877, s/o P & B; **Nicholson**, Melvine Johnson, b. 1900, d. 1992, Wife; **Picke**, June Callow, b. 1923, d. 1970, Mother; **Pofahl**, Amy J, b. 1896, d. 1988, Mother~Lawrence A, b. 1893, d. 1953, Father~Roy, b. 1919, d. 2002~Virginia J, b. 1921, d. 1942; **Prescott**, Valinda, b. 3 Sep 1953, d. 21 Sep 1953, Our Darling; **Prosser**, Mary Estella, b. 3 Dec 1862, d. 1 Dec 1949, Mother; **Roberts**, Elizabeth, d. 21 Oct 1867, age: 81y 11m; **Rork**, Daniel B, b. 1872, d. 1941~Estelle E, b. 1875, d. 1963; **Ryon**, Fred J, b. 1874, d. 1950, Father~Gertrude F, b. 1895, d. 1944, Mother; **Shaeffer**, Henry, b. 1865, d. 1942; **Shaw**, Joseph, d. 9 Jan 1853, age: 77y 9m; **Starns**, Samantha, d. 15 Oct 1851, age: 61y, Wife of John Starns; **Swaenepoel**, Carrie S, b. 18 Nov 1880, d. 4 Feb 1941~Juliet, b. 11 Oct 1886, d. 6 Dec 1946; **Talcott**, Judith, d. ????, age: 57y; **Taylor**, Larry D, b. 15 Jun 1850, d. 7 Mar 1994, Loving Father, Son, and Friend. Best Damn SS (shortstop) in Kenosha~Margaret L, b. 24 May 1928, d. , s/w William T Taylor~Ralph T, b. 1948, d. 1948, Son~William T, b. 30 Jun 1914, d. 8 Dec 1995, Jan 6 1945, Loving Wife and Mother, Loving Husband and Father "Look at All These Years Together", s/w Margaret L. Taylor; **Twist**, Isaac, d. 19 Nov 1878~Phoebe A, b. 24 Jan 1839, d. 18 Sep 1863, Daughter of Isaac and Elvira Twist; **Vale**, Alice, d. 16 Jul 1848, age: 53y, Wife of J Vale; **Voight**, Charles S, b. 1894, d. 1955, Sgt Engineer WWI; **Wattles**, Almira, d. 27 May 1871, age: 60y~Charles W, d. 22 Oct 1856, age: 22y 11m 2d, Son of Wm R and A Wattles~William P, d. 12 Jan 1858, age: 50y; **Whiteley**, Albert L, b. 8 Apr 1877, d. 12 Jan 1933~Albert R, b. 12 Apr 1849, d. 16 Feb 1922, Father~Cordelia E, b. 6 Apr 1843, d. 25 Jul 1931, Mother~J M, d. 22 Mar 1908~James, d. 15 Nov 1851~John R. b. 5 Sep 1888 d. 22 Jan 1903~John d. 19 Jul 1851~Joshua, d. ?? 1867~Mary Christiansen, b. 7 Aug 1871, d. 22 Aug 1916, Mother~Mary June, b. 11 Nov 1833, d. Aug 21 1902~Mary, d. 27 Dec 1863, age: 52y, Wife of Joshua Whiteley; **Whitney**, Sarah B, d. 12 Dec 1855, age: 62y, Wife of ?? II Whit-

## Prepare to go to Madison Historical Library

There have been discussions of taking a trip to do research in Madison at the Historical Society's wonderful library. There you can find books for information and copied records from all 50 states and Canada to use in your research. If you choose to go there in a group or on your own here's a few things you could do before you go. First, the libraries are open when the university is in sessions. Mon-Thurs open 8 am to 9 pm and Fri-Sat 8am-5pm . Archives is open Mon-Fri 8am-5pm Sat 8am-4pm. When the university is not holding classes the hours are Mon-Sat are 8am to 5pm. Retrieval of items by staff stops 1/2 to 1 hour prior to closing. Closed on Sundays and holidays. Check online at <http://www.wisconsinhistory.org/research.asp> for any change in hours or closures.

Before going to Madison:

Set up which of your ancestors, family groups or location you want to do research on to get information?

What questions do you want to solve? Prioritize them or group them whichever will work for you.

What information is missing from your research?

Make sure to write a list of what you are looking for.

Create a list of books, pamphlet, microfilms, etc. that you want to look at.

Hard candy or Gum is good for dry mouth while working in the stacks. Resealable bottle for liquids that is only opened when you are drinking from it.

To get a list of the books, pamphlet, microfilms, etc. you want to look at go to <http://search.library.wisc.edu/>

At the online search site you can do a search of the UW Madison Memorial library and the Historical library. These two libraries are across a small square from each other. So don't freak out if you find a book you want is in the other library.

The University's Archive is on the fourth (4) floor of the Historical Society Library. To search for its holdings go to <http://www.wisconsinhistory.org/research.asp>

Make a list of the book titles, library code, and the location of the item. A small lunch, sandwich, drink, fruit, veggies, and more importantly napkin and wet wash. But food not allowed in the stacks. Drink is allowed if it has resealable cap.

Do a guided or advanced search at <http://search.library.wisc.edu/> search screen.

I entered a search for Civil War and got the following:

1. "Pennsylvania Genealogy magazine" call letter CS42.P44 1970 at the History Library with these call letters you will find this book in the stacks. Also as a magazine there will probably be a box set.
2. "Genealogy of the Bavaria, Germany, Pittsburg {sic} Pennsylvania, Germany. Marathon County, Wisconsin" (This title is confusing to me too) History Library Pamphlet Collection 81-1150 1970. for pamphlets you have to fill out a small form you get at the information desk. You fill out the form and give it back to the staff there or leave in the box they have available for it. The staff will do retrieval every 15 to 30 minutes. And it is your responsibility to check if it's in.
3. "Republic and Civil War in Spain" is at the Memorial Library Stacks regular sizing selfing is in the University's library across the square from the History library DP257 C295 1971
4. "History of the Doles-Cook Brigade, army of Northern Virginia, C.S.A.: Containing Muster rolls of each Company of the Fourth, Twelfth, Twenty-First and Forty-Fourth Georgia Regiments with a short sketch of the services of each member of the regiments." (yes that is the title). You will find this in the History Library Microforms room. There are no call letters. It's called the microforms room because There is more than just microfilms in there. Assistance is in the Microforms room.

## WISCONSIN HISTORICAL SOCIETY LIBRARY AND ARCHIVES

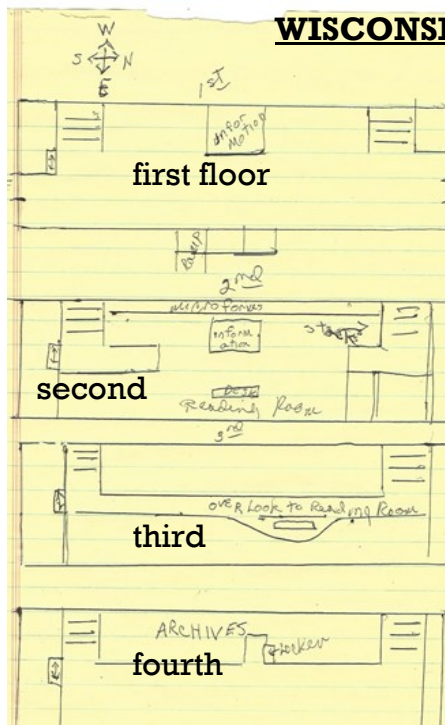

The Historical Society Library has 4 floors. The first floor is somewhat open with a member's desk, usually some displays. There are entries on three sides with a ramp available at the front entrance. The platform the building sits on has four set of steps. There are two steps on the north side with the father northwest has a ramp. Inside there are two sets of marble steps going up and on the south side is the elevator. This elevator is small holds maybe 4 people. Also has a tendency to be a little slow.

The second floor is the Reading Room plus the stacks and microforms room. There is a larger desk visible as you enter that is where you go to put in request for pamphlets. This information desk is run mainly by students. Into the Reading Room is the reference desk usually a librarian is available there. To the left is the computer area. The closest ones are reserved for genealogist.

To the right are plenty of tables and seats. Behind the larger desk is where the Microforms room is and assistance is available in the room. Alongside the larger desk are carts for researcher's use. Back and to the left is entry to the stacks. There are 7 levels to the stacks. In the stacks to the right are selves to leave the books on when you're finish with them. They prefer you not to restack. Then a narrow staircase with a door that leads to the other levels. Then next is a very small elevator that holds two people or one person and a cart. It has a door and screen. Wait for the outer door to close before picking the level then the screen will close on its own. There are signs telling which level in the stacks the call letters would be found. On either side of the reading room's outer areas there are benches to take lunch at.

The third floor has mainly offices but there is a little hallway that leads to a small overlook to the reading room a good place to take a lite lunch or relax for a few minutes.

The fourth floor about half way down on the left is the short hallway to the Archives. In that short hallway are lockers for your use. You can take pencil and paper, change or copy card, a camera or handheld scanner. Sometimes, the archived items maybe bigger and/or fragile and they prefer you not to try and put it in the copier. There's a desk for sign-in inside the doorway and a form to fill out so also bring ID.

GPS is the best way to get there. Or take Hwy 151/East Washinton Rd toward the capital. There are lots of signs. Either 1. turn right on first street then left at the next light onto Johnson. As you drive west the road spits, eastbound traffic is on Johnson and westbound traffic is on Gorham. Follow Gorham until it meets Wisconsin. Turn right and continues straight even thought Wisconsin will turn left. Another block down and the turns left on Langdon. Follow Langdon to Lake. There is a parking lot on lake ave if you turn left from Langdon. It's about 1 block up on the left. There is also a small parking lot if you continue on Langdon on the right and on the street. Most of these are metered with time limits. If you have a handicap plaque, metered parking is free for any meters 2 hours or more.

(Continued from page 2)

### **VALE CEMETERY**

#### **Misc:**

??, ??, b. ??, d. 21 Dec 1880, Broken Stone; ??, ??, d. 18 Feb ????, Broken Stone; ??, Elizabeth, d. ?? Oct ????, age: 81y ?m 21d; ??, Oarte Augh??, b. ??, d. ??, Broken Stone; **Bagley**, Del, no data, Lot #10; **Farnham**, Sarah, no data, Lot #39; **Frank**, Arthur, no data, Lot #21, S½; **Hatch**, A.S, no data, Lot #28~A.V., no data, Lot #28; **Heatbon**, L. W., no data, Lot #50; **Olsen**, I., no data, SE Corner Lot #56; **Otis**, Erastus, no data, Lot #33; **Shaffer**, ??, no data, plot next to Lot #9; V, A, no data; **Voight**, M. C., no data, SW Corner Lot #24

#### **References:**

1. [www.GenealogyBank.com](http://www.GenealogyBank.com)
2. <http://wsgs.org/cpage.php?pt=126> ~WKSOGS Newsletter, Vol 38, No. 4, April 1992
3. <http://www.rootsweb.ancestry.com/~wikenosh/vale.htm> ~ Kenosha County WI Gen Web
4. [http://www.kenoshanews.com/news/\\_~\\_](http://www.kenoshanews.com/news/_~_) ~ Fix it old cemetery gets some needed attention
5. <http://www.archives.com>

### **RECOMMENDED WEBSITES**

<http://billiongraves.com/pages/>

<http://www.funeralhomes.com/go/listing/ShowListing/USA/Wisconsin>

<http://www.libdex.com/country/usa/wisconsin/>

<http://digicoll.library.wisc.edu/wiarchives/>

<http://uwdc.library.wisc.edu/collections/History>

#### **Elected Officers**

President ~ Judy Uelmen  
Treasurer ~ Frank Klein

Vice-president ~ Claudia Schiller  
Secretary ~ Mary Ann Cole

#### **Appointed Officers**

Digital Equipment Operator ~ Don Kueny  
Sunshine Committee ~ Claudia Schiller  
Webmaster ~ Jeff Huff

Librarian/Historian ~ Suzanne Dibble  
Surname ~ Paula Frye  
Publicity ~ Judy Reynolds

#### **Contact Information**

Website ~ [www.kengensoc.com](http://www.kengensoc.com)  
Judy Uelmen (President) ~ [juelm@aol.com](mailto:juelm@aol.com)  
Paula Frye (Newsletter Editor) ~ [prfrye@hotmail.com](mailto:prfrye@hotmail.com)

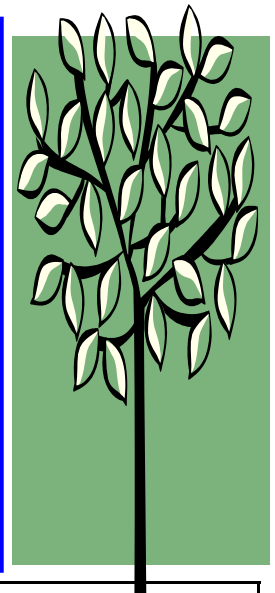

#### **Disclaimer**

While we try to avoid errors, the editor does not assume any liability for any part of any loss or damage caused by errors nor omissions, whether such errors or omissions result from negligence, accident or any other cause. This newsletter is the official publication of KCGS and reserves all rights. No articles herein may be reproduced for profit or commercial gain without the express written consent of KCGS. Members wishing to submit articles may e-mail them to: [prfrye@hotmail.com](mailto:prfrye@hotmail.com). Please put "Newsletter" in the subject line. As space permits, articles will be used, but NO copyrighted articles will be used without permission from the author or publisher.